

## TAC-05 CARTRIDGE REPLACEMENT (P/N 7000554)

**AFFECTED PRODUCTS:** TAC-05, TAC-10

**PARTS INCLUDED:**

**7000554 TAC-05 Cartridge Kit (Single)**

- 1 TAC-05 Cartridge (P/N 2090149)
- 1 Giant Bowl O-ring Kit (P/N 7000556)
- 1 Instruction Sheet (P/N 1010461)

**TOOLS:** Filter Wrench (included with the TAC System when purchased), Bucket

### General

If you experience any problems with these instructions, contact Antunes Technical Service at +1-877-392-7854 toll free.

### Replacing the TAC Cartridge

The procedure for replacing the TAC Cartridge involves depressurizing the system, replacing the cartridge, and then repressurizing and flushing the system.

#### DEPRESSURIZING THE SYSTEM

The system must be depressurized before replacing the TAC Cartridge.

1. Turn off water to the system by closing both the Inlet Valve and Outlet Valve.
2. Press the Red Pressure Relief Button to depressurize the system.

#### REPLACING THE CARTRIDGE

1. Unscrew the TAC Housing counter clockwise to remove the housing from the system (Figure 1).
2. Empty any water inside the TAC Housing into a drain and discard the old TAC Cartridge.
3. Inspect the O-ring on the TAC Housing and replace if it is cracked, twisted, or missing.
4. Lubricate the O-ring with an approved food grade lubricant and install onto the housing (Figure 1).
5. Remove the plastic wrap from the new TAC Cartridge and install into the TAC Housing with the End Gasket facing the TAC Housing Head.

**NOTE: Make sure the end seal gasket is retained on the end of the TAC Cartridge in the recessed groove (Figure 1). Be careful that the gasket does NOT fall off when placing the cartridge into the TAC Housing.**

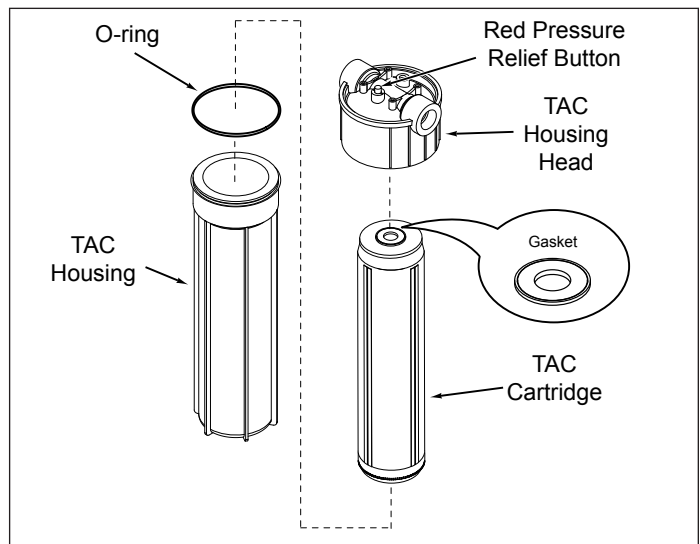

**Figure 1. Replacing the TAC Cartridge**

6. Screw the TAC Housing (containing the new TAC Cartridge) into the TAC Housing Head (Figure 1). Tighten the housing until it stops. The housing will come to a hard stop at the end of the thread. Use the Filter Wrench, if necessary.

**NOTE: Do NOT overtighten the TAC Housing.**

#### REPRESSURIZING AND FLUSHING THE SYSTEM

1. Direct the outlet of the system to a bucket or drain.

**NOTE: Do NOT use the water produced during rinsing. Direct this water to a drain.**

2. Turn on the water to the system by opening the Inlet Water Valve. Allow water to flow through the Housing to rinse out trapped air and any debris that may be present.
3. To help remove the trapped air from the Housing, press the Red Pressure Relief Button on top of the Housing Head until water just begins to come out.
4. Rinse the system for five minutes.

**NOTE: Do NOT consume the water used for flushing the TAC Cartridge.**

5. When the rinsing is complete, close the Inlet Valve and reconnect the water to service.
6. When the system is reconnected, turn on the water by opening the Inlet and Outlet Valves.