

## Carbon Element Kit (P/N 7010000)

### PARTS INCLUDED:

- 1 Carbon Element
- 1 Glove and Carbon Sticker Kit
- 1 O-ring Kit
- 1 Instruction Sheet

**TOOLS:** Filter Wrench (Not included with kit, see P/N 2180611), Bucket, Gloves

### General

If you experience any problems with these instructions, contact Antunes Technical Service at +1-877-392-7854 toll free.

### Replacing the Carbon Element

Replacing the Carbon Element involves depressurizing the system, replacing the cartridge, and then repressurizing and rinsing the system for use.

#### Depressurizing the System

The system must be depressurized before replacing the Carbon Element.

1. Attach a hose to the Rinse Valve and direct the hose to a drain (Figure 2).
2. Turn off water to the system by closing both the Inlet Valve and Outlet Valve.
3. Open the Rinse Valve and allow the system to drain to ensure the permeate tank is empty.

#### Replacing the Carbon element

1. When the system is depressurized, unscrew the Filter Housing from the system.
2. Empty any water inside the Filter Housing into a drain and discard the old Carbon Element.
3. Inspect the O-rings on the Filter Housing and replace if cracked, twisted, or missing.
4. Lubricate the O-rings with an approved food grade lubricant and install onto the Filter Housing (Figure 1).
5. Put on gloves. Place the new Carbon Element into the Filter Housing.

**NOTE:** Remove the plastic wrap from the Carbon Element before use. Make sure the end seal gaskets are in place on both ends of the Element. The gaskets are retained on the end of the Element. Be careful that the gaskets do not fall off when removing the plastic wrap or when placing the Element into the Filter Housing

6. Screw the Filter Housing into the Head until it stops (Figure 1). Use a Filter Wrench, if necessary.

**NOTE:** DO NOT overtighten the Carbon Element Housing.

**NOTE:** Direct the Rinse Valve hose to a drain. DO NOT use the water resulting from the rinse procedure.

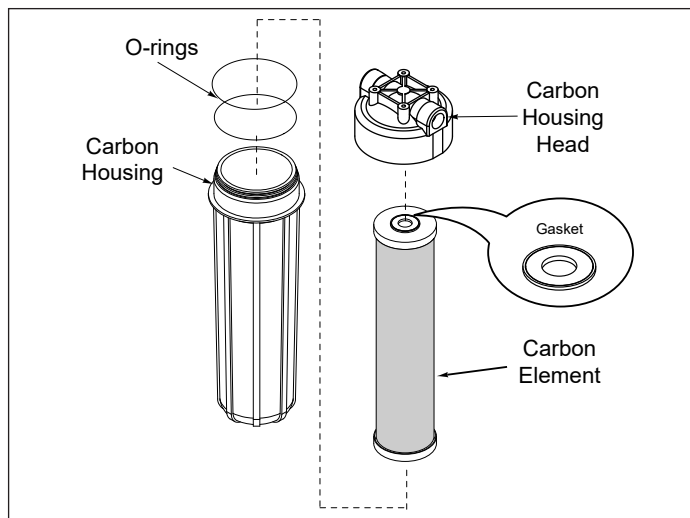

Figure 1. Replacing the Carbon Element

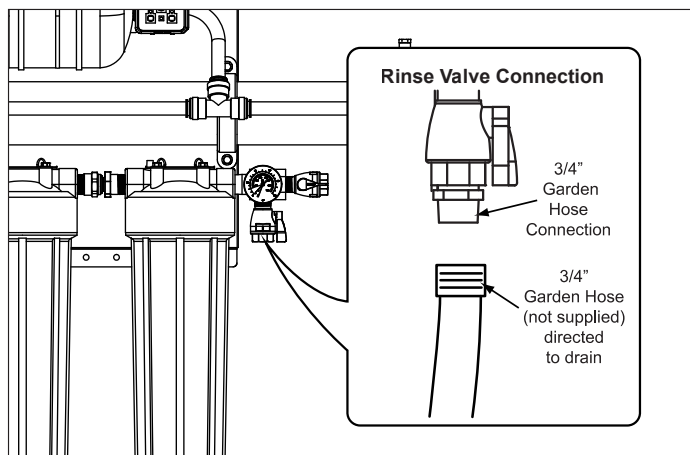

Figure 2. Rinse Valve Connection

#### Rinsing the Carbon Element

1. Open the Rinse Valve. Turn on the water to the system by slowly opening the Inlet Valve. Allow water to flow through the Carbon Element and Housing. This clears out trapped air and any carbon fines.
2. Rinse the system for five minutes.

**NOTE:** Do NOT consume the water used for rinsing the Carbon Element. Direct this water to a drain.

3. When rinsing is complete, close the Rinse valve and disconnect the rinse hose.
4. Open the Outlet Valve. The system is now ready for use.
5. Write the replacement date on the included Change Label and place it in a visible location on the Housing.