



# PERFECTLY COOKED EGGS MADE-TO-ORDER

The Egg Station Mini makes it easy for operators to quickly serve fresh, made-to-order eggs for menu items in any daypart. With a footprint smaller than any other available Egg Station and interchangeable egg rack configurations, this ventless unit allows operators to move eggs, omelets, and scrambles off the grill while requiring very little additional space in the kitchen.

Using a combination of heat from the grill surface and steam, the unit cooks perfectly moist eggs in only a matter of minutes. No hassle, no guesswork. The heated grill surface cooks the eggs while the rings give the product its shape. Steam is created under the cover that is lowered over the rings. As water is poured into the trough on the cover, it drips down onto the platen, which produces steam to keep the eggs moist and accelerate the cooking process.



#### Easy-to-use Buttons

Bilingual label (English/French) on control panel with color-coded buttons.



#### High Capacity

Cooks a maximum of six round eggs.

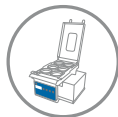

#### Small Footprint

Small footprint to easily fit into any operation.

Serve perfectly cooked eggs made-to-order from the smallest footprint in your kitchen.

Model: ESM-600 Egg Station Mini



# Egg Station Mini | ESM-600

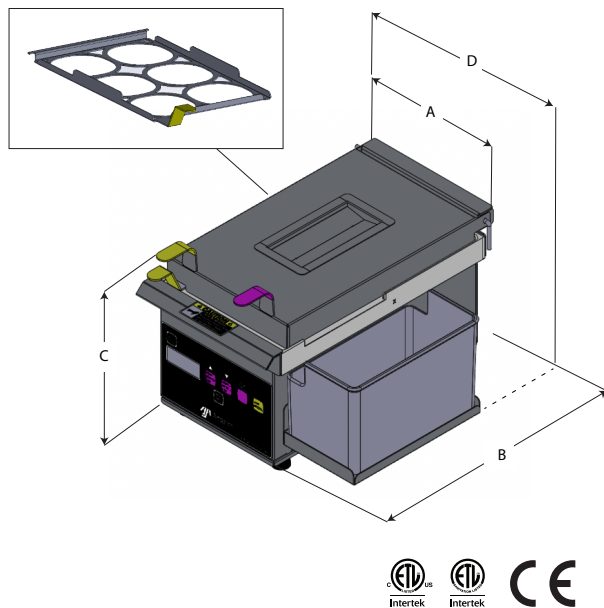

## Features:

- Small footprint to easily fit into any operation.
- 120V / 15A cord plugs into basic electrical outlets for easy movement to any kitchen countertop.
- Moves eggs off the grill to eliminate potential for cross-contamination.
- Cooks a maximum of six round eggs.
- No hoods or vents required for operation.
- Easy to clean.
- Four adjustable legs for an even grill surface.
- Bilingual label (English/French) on control panel with color-coded buttons.
- Egg-cracking bump outs on racks.
- Color-coded handles for food safety.

### ESM-600

### Electrical Ratings

### Dimensions

Model & Mfg. No.	Approvals	Volts	Watts	Amps	Hertz	Plug Configuration	Width (A)	Depth (B)	Total Width (D)	Weight
ESM-600 9300649		120	1500	12.5	50/60	5-15, 15 Amp., 120VAC	19" (483 mm)	18" (457 mm)	13" (76 mm)	45 lbs (20.41 kgs)

### Egg Rings

Part No.	Description
2130193	Egg Ring ½-inch 3-inch PTFE inside diameter

