

Muffin Toaster | MT



BREAKFAST MADE EASY

The MT-12 Muffin Toaster has been a reliable staple in the McDonald's system since its release in 1996. Today, it is still used as the baseline for Gold Standard muffin toasting.

The MT-12 toasts up to 6 English muffins (12 halves) at a time. A temperature sensing control measures internal temperatures in the toasting chamber and adjusts the time accordingly. This produces perfectly toasted English muffins with the consistency you need to satisfy customers.

The partial load switch and energy conservation mode for idle periods allow operations to toast muffins on demand easily throughout the day.



MT-12 Muffin Toaster



High Capacity Toasting

Toasts up to 324 English muffins per hour and up to 6 English muffins at a time

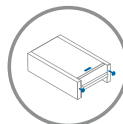

Small Footprint

Allows operations to accommodate the All Day Breakfast program



Cleaning Made Easy

Removable crumb tray for easy cleaning



Muffin Toaster | MT

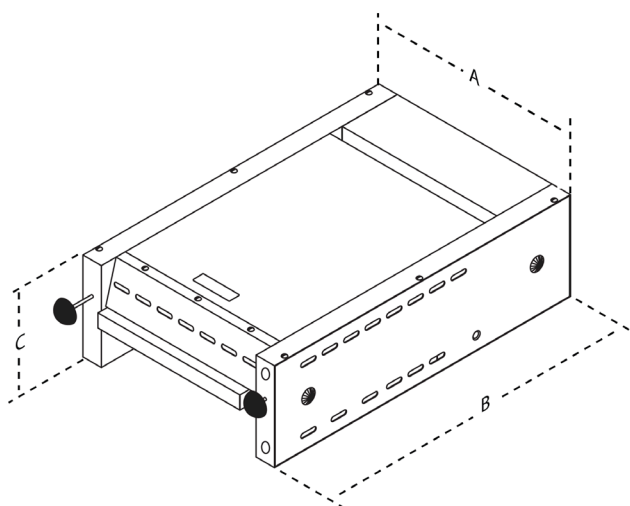

Features:

- Automatically measures internal temperature of the toasting chamber and adjusts the toast time
- Redesigned controller and upgraded software for improved quality and consistency
- Partial-load switch for toasting 3 or less muffins
- Energy-conservation mode automatically reduces power consumption by 75% when the chamber is empty
- Toaster alerts operator with audible signal and a ready light when muffins are done
- Optional spatula is available from your KES

Specifications:

Warranty: 2 years parts and labor

Note: Order from your KES or talk to your equipment manager

MT	Dimensions			Shipping Dimensions					
	Model & Mfg. No.	Width (A)	Depth (B)	Height (C)	Operating Weight	Width	Depth	Height	Weight
	MT-12	15 5/8" (397 mm)	26 5/8" (676 mm)	8 1/8" (206 mm)	56 lbs. (25 kg)	20" (508 mm)	13" (330 mm)	30" (762 mm)	57 lbs. (26 kg)

Electrical Ratings and Plug Configurations

Model & Mfg. No.	Volts	Watts	Amps	Hertz	Plug Description
MT-12 9200131	200-240	3400	17.0	50/60	Marechal Pin & Sleeve 32 Amp., 220-250 Volt
MT-12 9200134	200-240	3400	17.0	50/60	NEMA L6-30P
MT-12 9200136	200-240	3400	17.0	50/60	HBL Pin & Sleeve 30 Amp., 250 Volt
MT-12 9200137	200-240	3400	14.8	50/60	IEC-309 230 Volt. Non- Molded Plug
MT-12 9200138	200-240	3400	14.8	50/60	IEC-309 16 Amp., 240 Volt Pin & Sleeve
MT-12 9200140	200-240	3400	17.0	50/60	IEC-309 32 Amp., 250 Volt Pin & Sleeve
MT-12 9200144	200-240	3400	17.0	50/60	L6-20P, 20 Amp., 250 Volt
MT-12 9200150	200-240	3400	16.3	50/60	Marechal Pin & Sleeve 32 Amp., 220-250 VAC (New Zealand)